

L-Banner

Spare Parts List

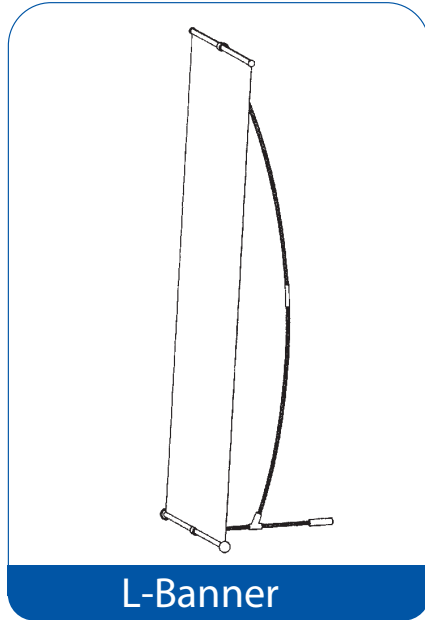

Horizontal top and foot pole, each one piece:

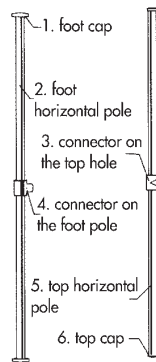

High, low and mid support pole, each one piece

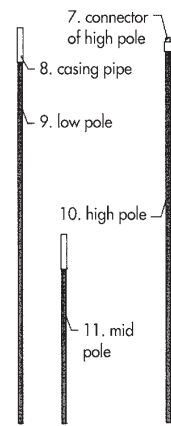

One piece base pole:

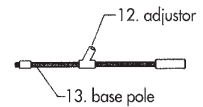

PVC sheet attached inside the top and foot pole:



Step by Step Assembly

Step 1

Take off the caps on the top and foot pole

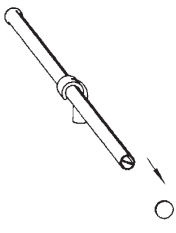

Step 2

Take off the PVC sheet which is inside the poles, clip the finished picture and insert them together into the top and foot poles. Make sure it is the correct side.

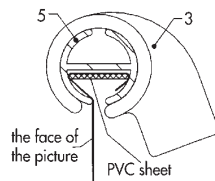

Step 4

Screw the base pole into the foot pole, tighten.

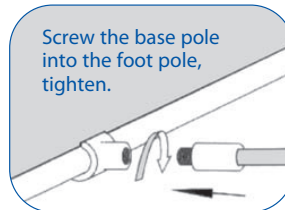

Step 5

Put the high support pole into the connectors marked 7 and 8, tighten. Now the high and low pole should be one completed pole.

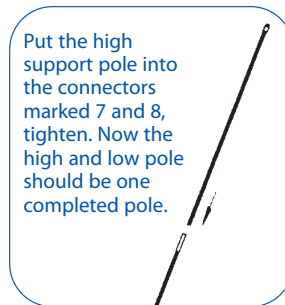

Step 6

Put the completed pole into the connectors on top and foot pole respectively. That's a finished display.

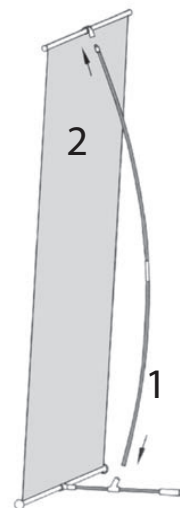

Step 3

Then put on the caps

